

RESIDENTIAL / NON-RESIDENTIAL (circle)

NAME: _____

SERVICE ADDRESS: _____

PLUMBER NAME: _____

DATE SUBMITTED: _____

BACKFLOW PREVENTER (BFP):

TYPE: (circle) RPBA OR DCVA

MAKE: _____

MODEL: _____

SIZE: _____

PLEASE COMPLETE AND RETURN TO:
ERIE WATER WORKS ENGINEERING DEPARTMENT
240 WEST 12TH STREET, ERIE, PA 16501
PH: (814) 870-8000 EXT 207, FAX: (814) 870-8011
backflowprevention@eriewaterworks.org

APPROVED BY: _____

DATE APPROVED: _____

APPROVAL RETURNED: _____

NOTES:

THIS DETAIL EWW-SD-004A IS FOR DOMESTIC WATER SERVICES WHERE A TESTABLE BACKFLOW PREVENTER IS REQUIRED AND WHERE A CONTINUOUS ROLL OF COPPER FROM CURB BOX TO INSIDE WALL OF THE HOUSE OR STRUCTURE CAN BE INSTALLED. ABSOLUTELY NO FITTINGS / SPLICES ARE ALLOWED. A HEATED ENCLOSURE WILL BE NECESSARY IF THE SERVICE REQUIRES MORE THAN ONE CONTINUOUS ROLL OF COPPER.

1. COMPOUND AND TURBINE METERS REQUIRE STRAIGHT PIPE LENGTHS A MINIMUM OF 4 PIPE DIAMETERS IMMEDIATELY UPSTREAM OF THE STRAINER/METER AND A MINIMUM OF 4 PIPE DIAMETERS DOWNSTREAM OF THE STRAINER/METER AND BEFORE ANY OTHER APPURTENANCES. 3/4" TO 2" T-10 TYPE METERS DO NOT REQUIRE MINIMUM STRAIGHT PIPE LENGTHS UPSTREAM AND DOWNSTREAM OF THE METER. CONTACT EWW ENGINEERING DEPARTMENT IN ADVANCE TO DETERMINE REQUIRED METER TYPE.
2. SCHEDULE AN INSPECTION WITH THE EWW ENGINEERING DEPARTMENT AT LEAST 24 HOURS PRIOR TO INSTALLING AND BACKFILLING SERVICE LINE AND METER PIT.
3. ALL EWW SPECIFICATIONS MUST BE MET BEFORE WATER SERVICE IS INITIATED.
4. THERMAL EXPANSION SHALL BE ADDRESSED BY CUSTOMER'S PLUMBER. CHECK LOCAL PLUMBING CODES FOR REQUIREMENTS.
5. FOR DOMESTIC SERVICES 4" AND LARGER, OR ANY PROPOSED SERVICE DIFFERENT THAN ILLUSTRATED HERE, AN ENGINEERED PLAN MUST BE SUBMITTED TO THE EWW ENGINEERING DEPARTMENT FOR APPROVAL.
6. ALL PIPES, FITTINGS, AND FIXTURES IN CONTACT WITH POTABLE WATER SHALL BE LEAD FREE PER THE REDUCTION OF LEAD IN DRINKING WATER ACT AND NSF/ANSI STANDARD 61 (NSF-61).
7. ALL MATERIALS FURNISHED AND INSTALLED MUST COMPLY WITH THE PENNSYLVANIA STEEL PRODUCTS PROCUREMENT ACT.
8. ALL PIPING SHALL BE TYPE K SOFT COPPER FROM THE WATER MAIN TO THE CUSTOMER'S STOP & WASTE VALVE, WHICH MUST BE CONNECTED TO THE TYPE K COPPER USING A SOLDER, FLARE, OR PROPRESS FITTING. COMPRESSION FITTINGS ARE NOT PERMISSIBLE. ONLY COPPER AND/OR BRASS PIPE AND FITTINGS CAN BE UTILIZED TO THE BACKFLOW PREVENTER.
9. ANY MODIFICATION MUST BE APPROVED BY THE EWW ENGINEERING DEPARTMENT IN ADVANCE.

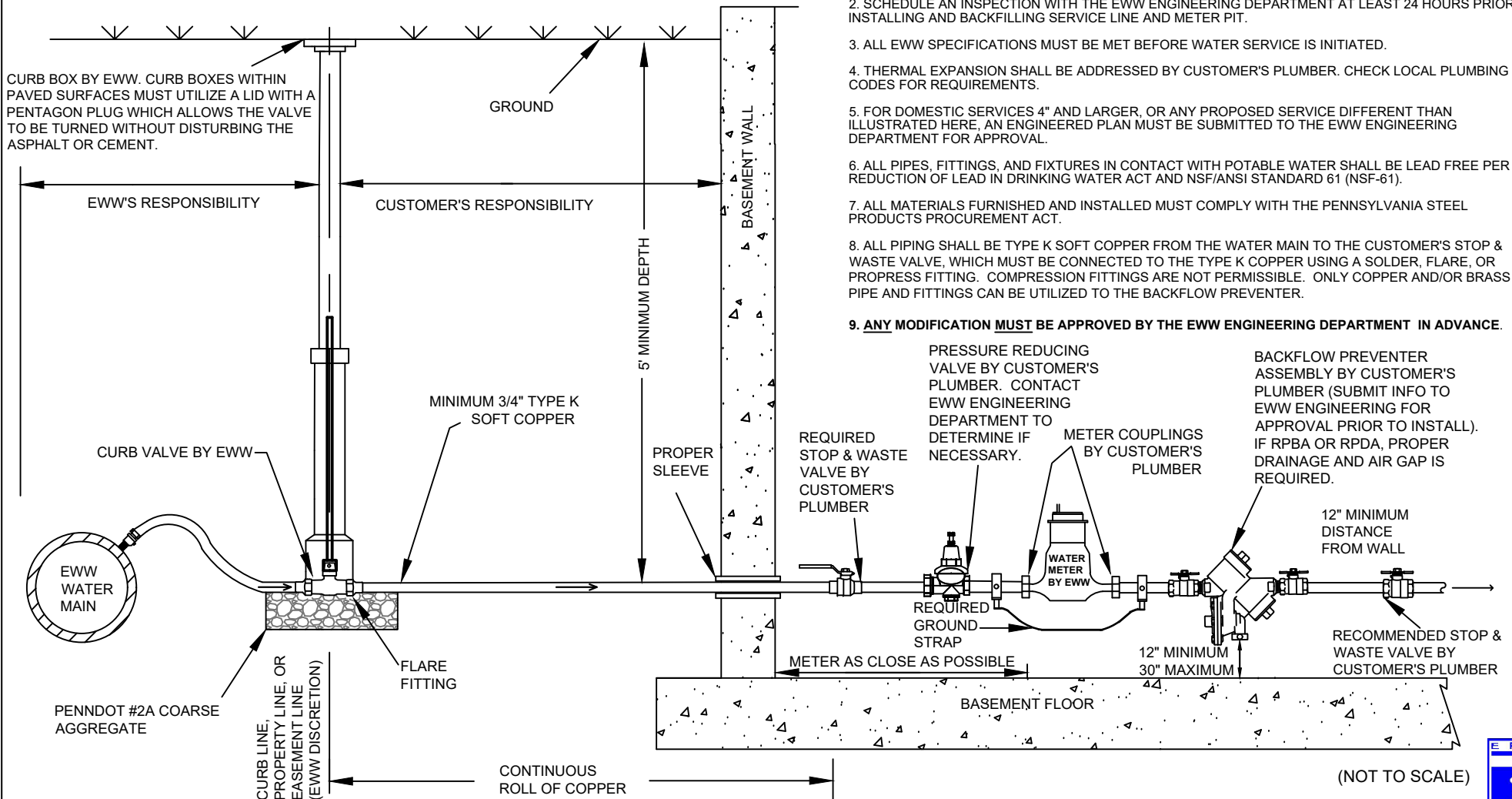

(NOT TO SCALE)

DRAWN BY: RD	APPROVED BY: CP
DATE: MAR 2020	EW - SD - 004A

DOMESTIC SERVICE W/ BFP (CONTINUOUS ROLL OF COPPER)

ERIE WATER WORKS
240 West 12th Street
Erie, PA 16501
engineering@eriewaterworks.org

